

1 PLANTA BAIXA
1 : 75

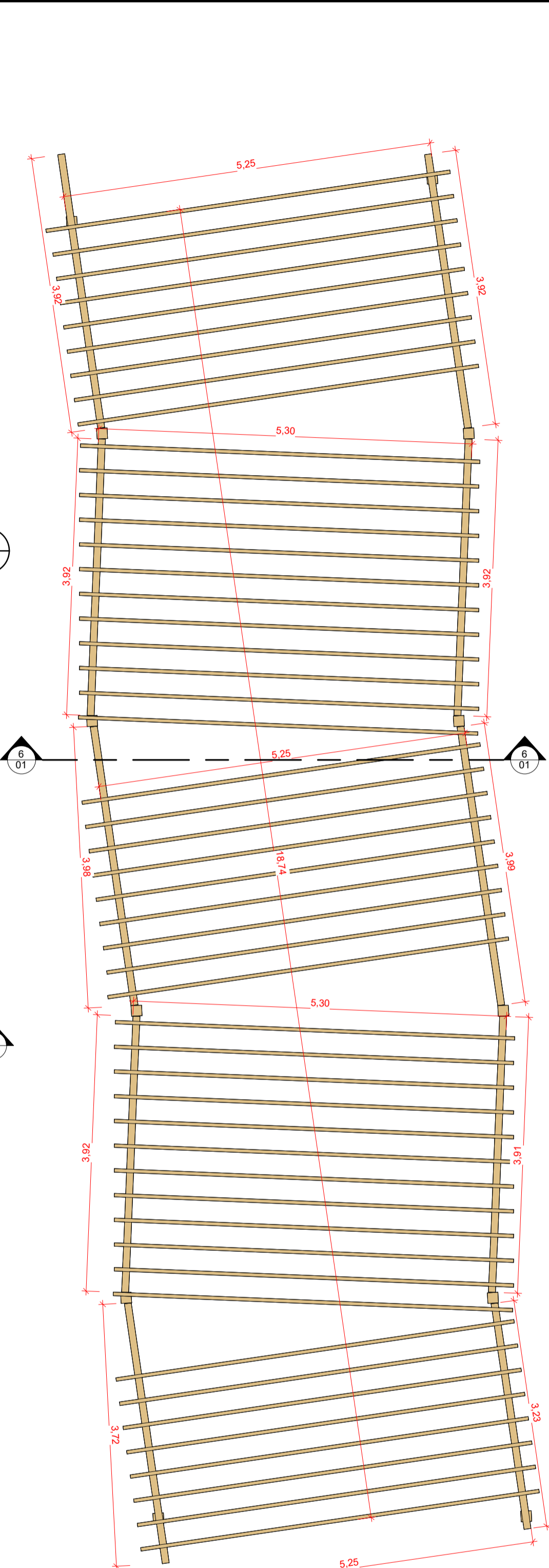

2 PLANTA BAIXA - PERGOLADO
1 : 50

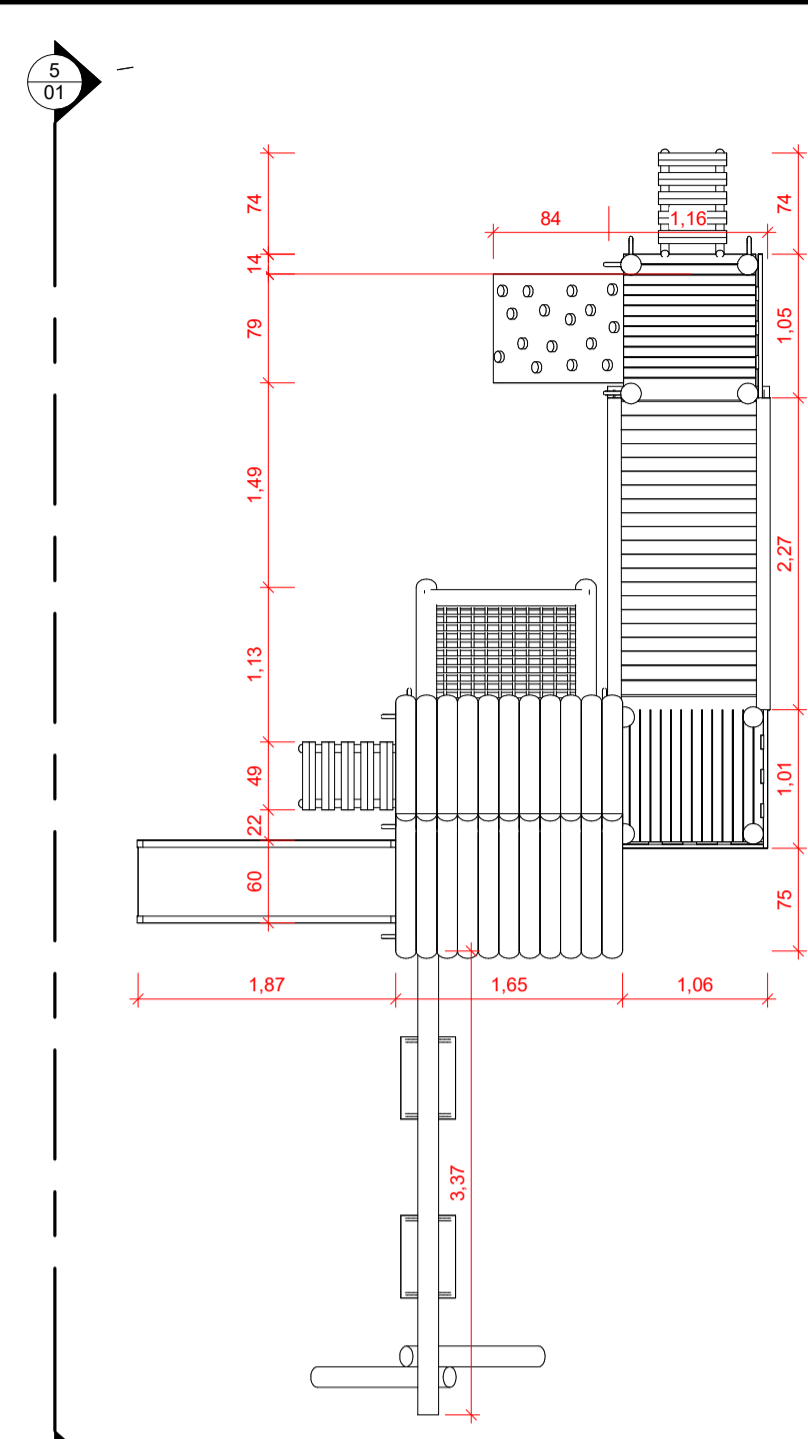

3 3D PLAYGROUND

4 DET - BRINQUEDO PLAYGROUND
1 : 50

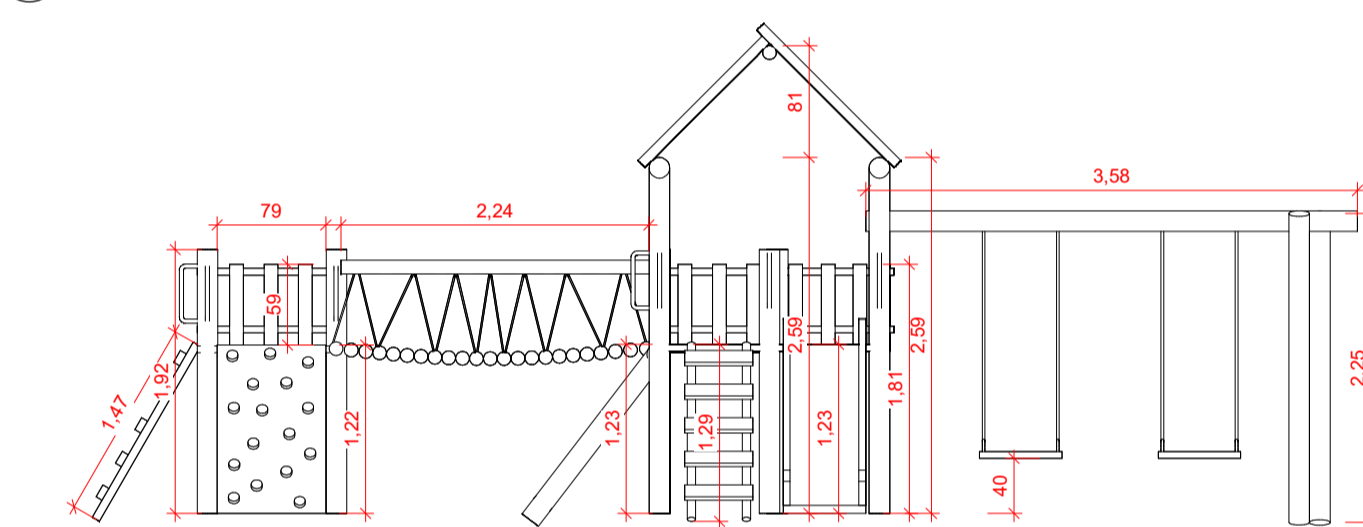

5 CORTE BRINQUEDO PLAYGROUND
1 : 50

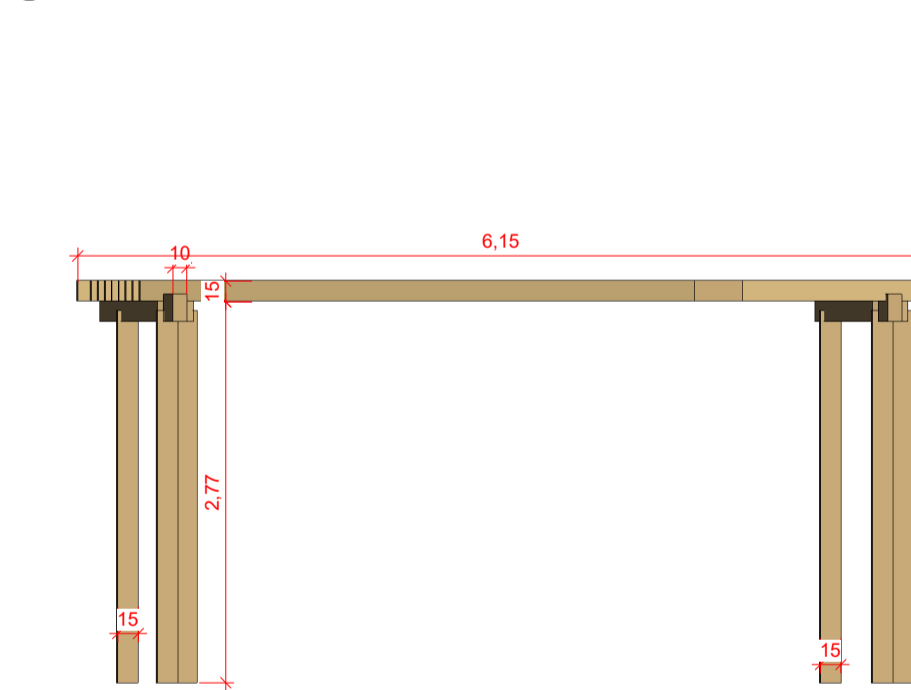

6 CORTE PERGOLADO
1 : 50

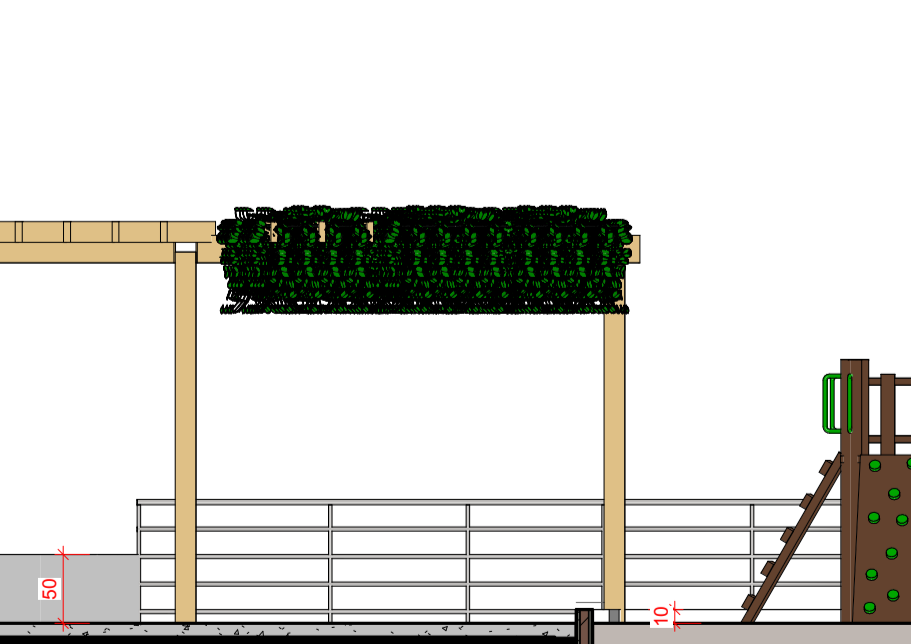

7 CORTE BB
1 : 50

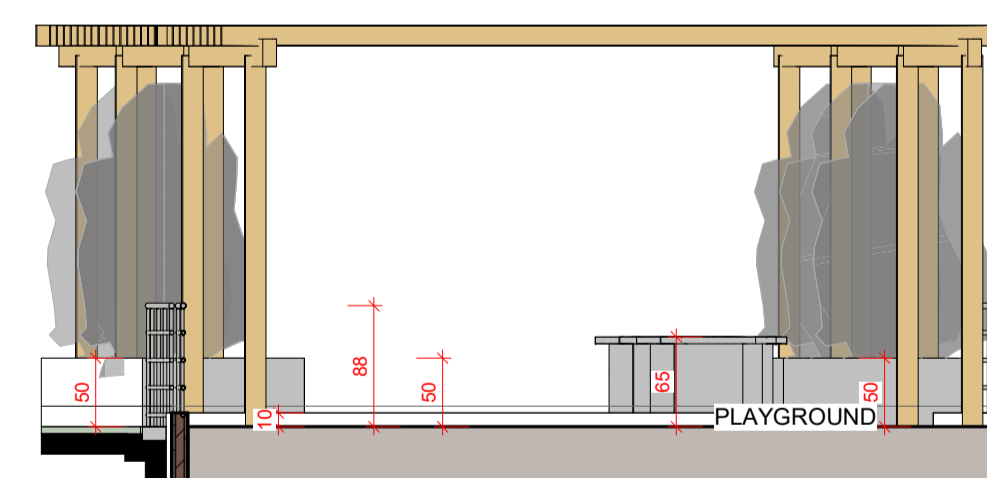

10 3D GERAL

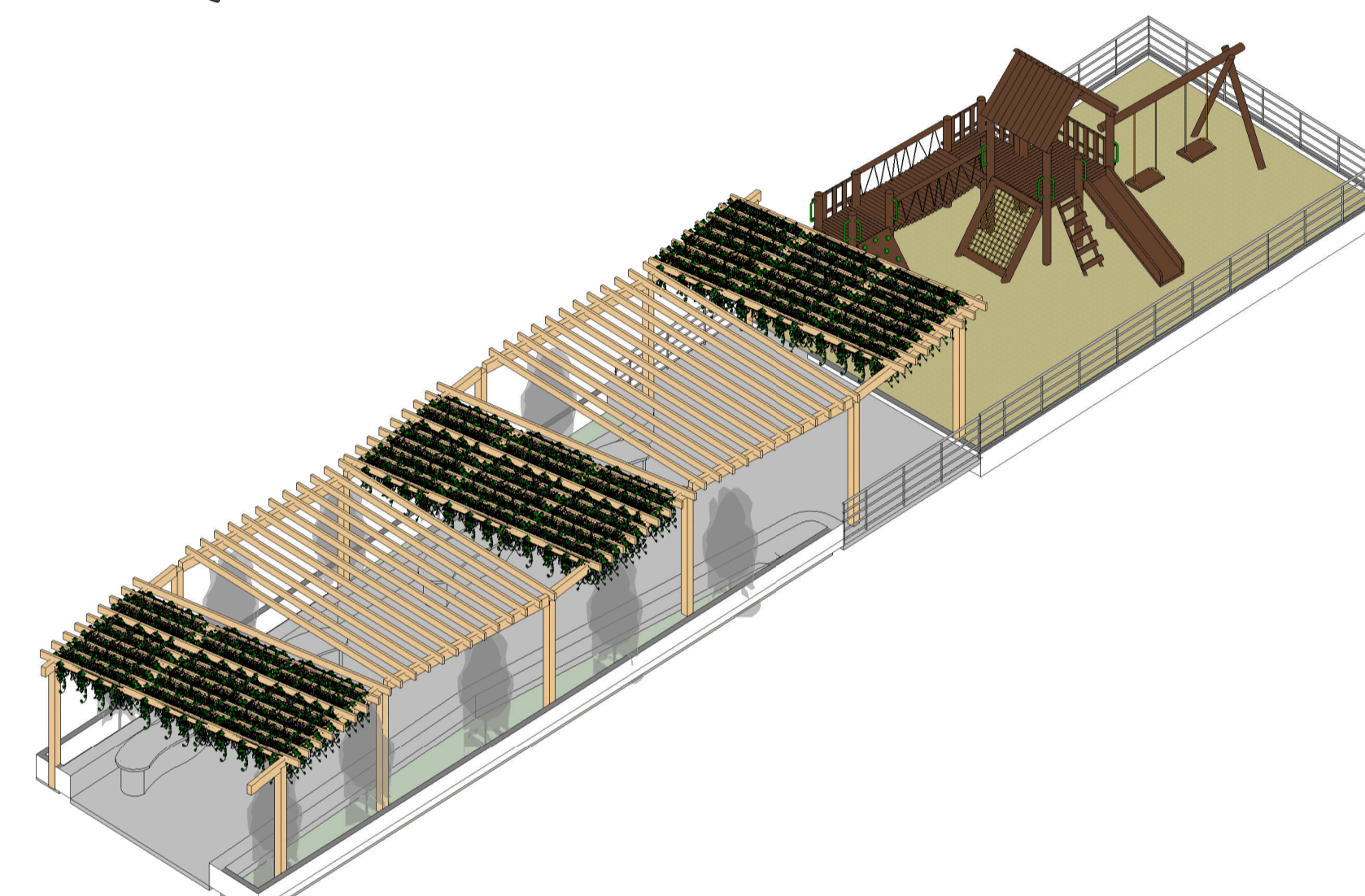

3 SITUAÇÃO
1 : 150

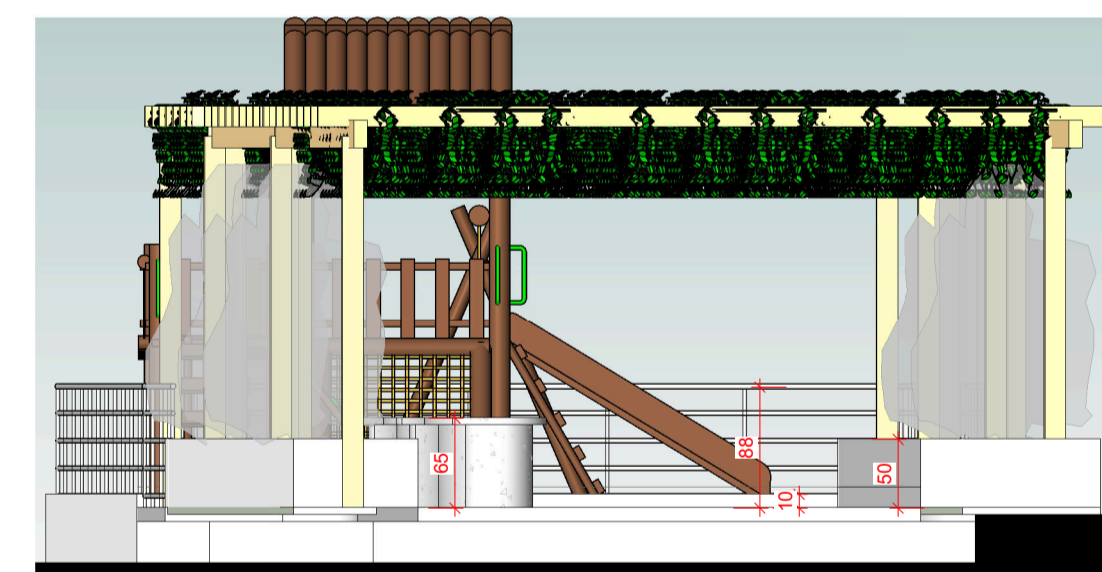

11 FACHADA PRINCIPAL
1 : 50

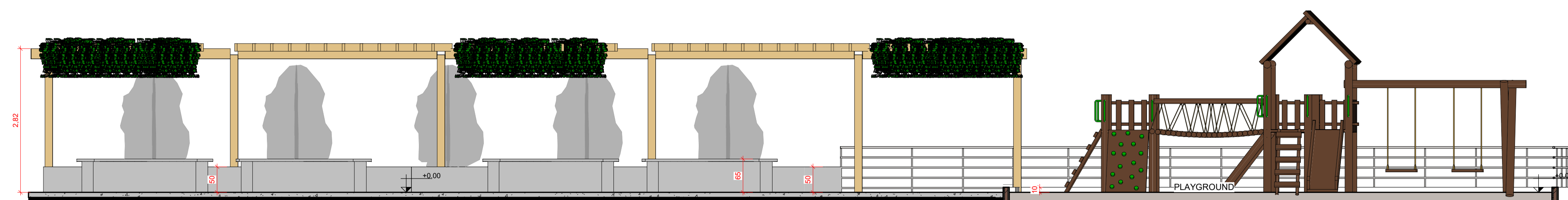

8 CORTE AA
1 : 50

 PREFEITURA DE SANTARÉM		SECRETARIA MUNICIPAL DE INFRAESTRUTURA	
ADMINISTRAÇÃO: JOSÉ MARIA TAPAJÓS		SECRETÁRIO MUNICIPAL DE INFRAESTRUTURA: ENGº CIVIL SÉRGIO GOUVEA DE MELO	
ASSUNTO:			
PROJETO: Planta baixa, Localização, cortes, 3D, Detalhes LOCAL: Rua dos Cravos - Bairro Alvorada - 68047090 PROPRIETÁRIO: Prefeitura Municipal de Santarém			
CONTRATO:		EQUIPE TÉCNICA:	
AUTOR: Arq. Thyago bentes		Arq. Thyago bentes Eng. Sérgio Melo Eng. Rafael Queiroz Eng. Rodrigo Willers	
ARTISTAS:		DATA: Março de 2026	
REVISÃO: 03		ESCALA: Indicada	
COMP:		FOLHA:	
LARGURA:		ÁREA PAV:	
ÁREA TOTAL: 181,18m²		1/1	